

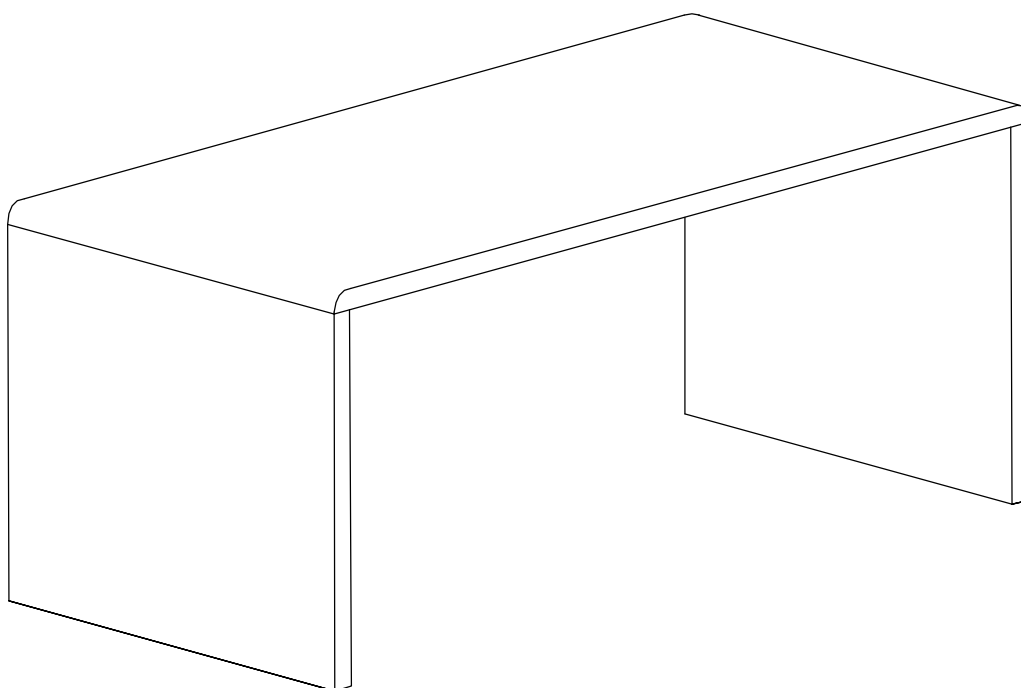

Assembly Instruction

**ARC DESK
OTARCDESK**



Important
Estimated Assemble Time:30min



MORE THEN 1 PERSON
IS REQUIRED TO SAFELY
ASSEMBLE THE ITEM



HOTLINE



ASSEMBLE ON A CLEAN,
FLAT SURFACE

Tools Required For Assembly

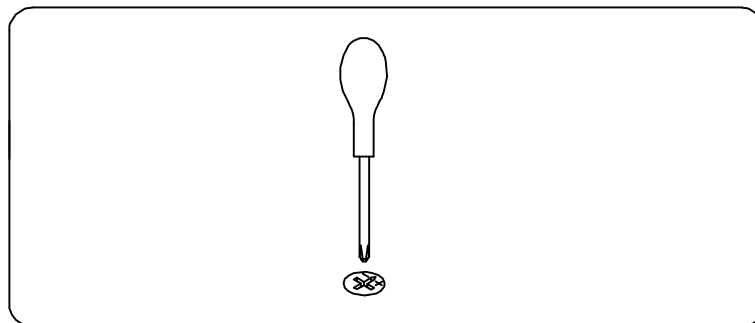

Please check you have all hardware components before assembling.

If you are missing any hardware components from the Hardware List please contact My Zone on
Tel:(03)9310 3011 or Email:hardware@myzone.net.au

Please ensure you have the name of the item,store purchased from,hardware part requited and quantity.

If you are missing any panels from the Panel List Please contact your store of purchase.

Please retain your receipt to validate warranty.Enjoy your new purchase!

Panel List

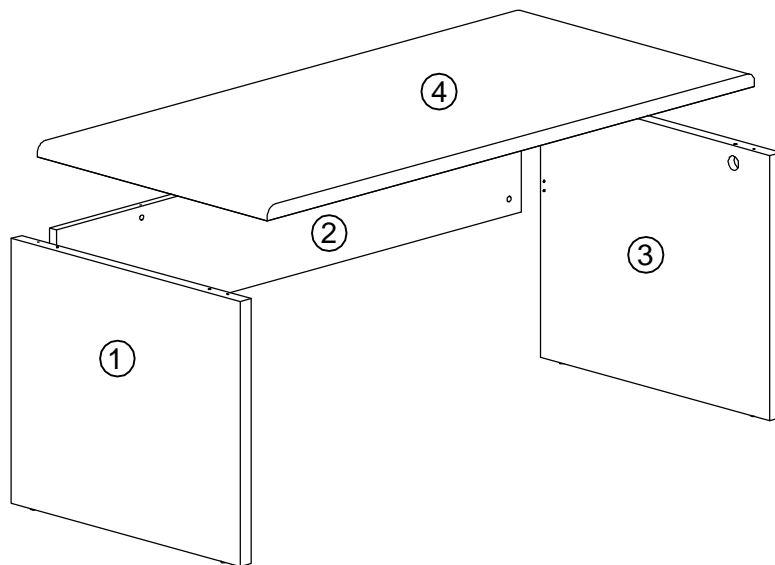

Hardware List

A

B

C

D

E

F

G

H

I

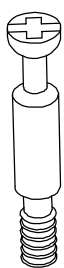

6×35mm
×7pcs



15×12mm
×7pcs



Ø8×30mm
×10pcs

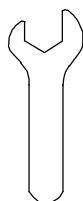

×1pc



×7pcs

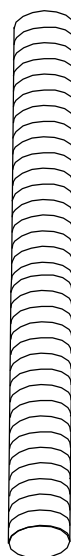

M8×75mm
×4pcs

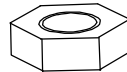

M8
×4pcs

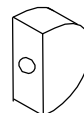

×4pcs

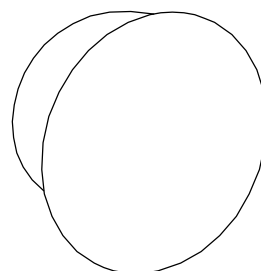

×4pcs

Step 1

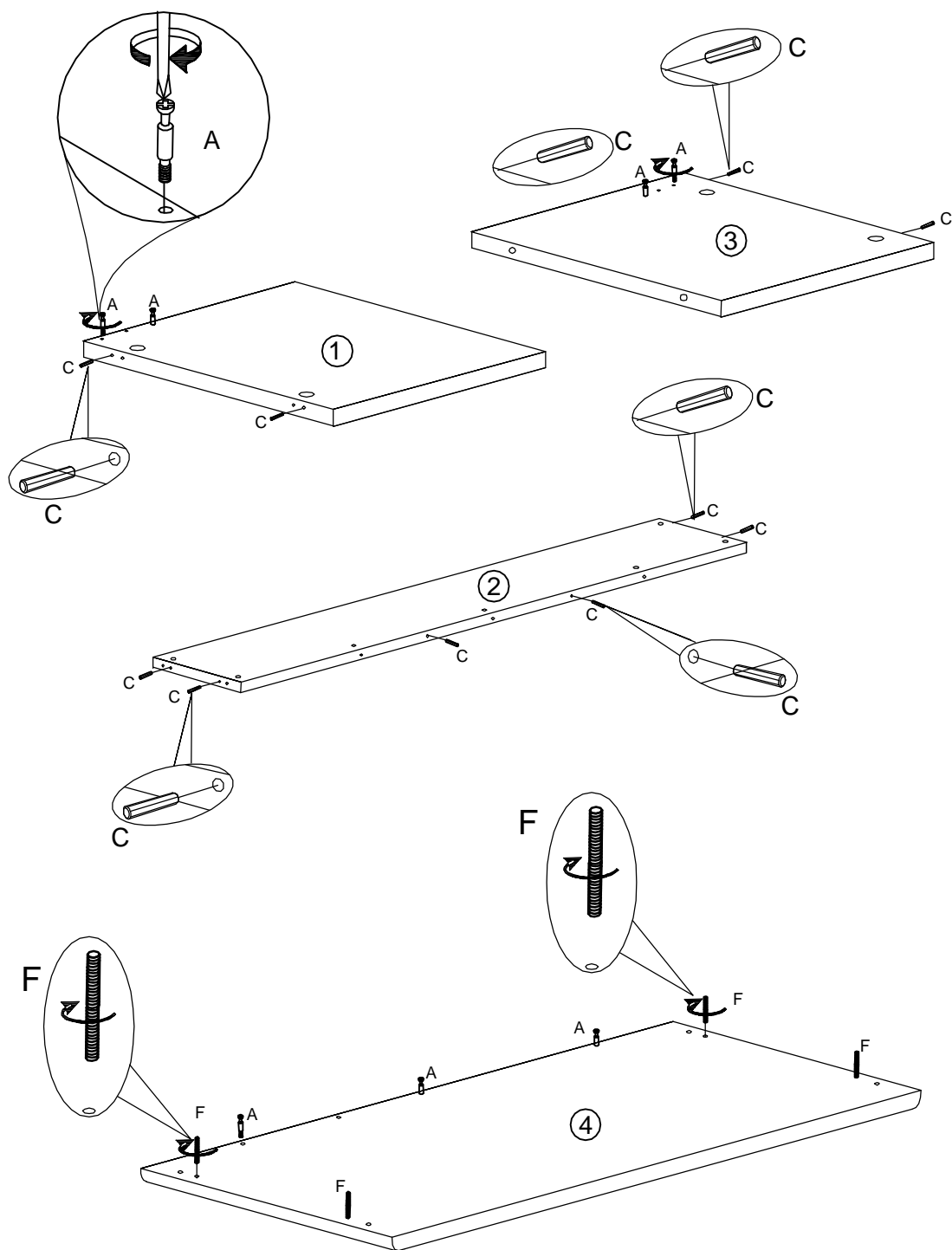

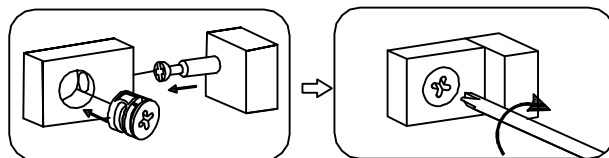

Please hand tighten this with screwdriver!

Step 2

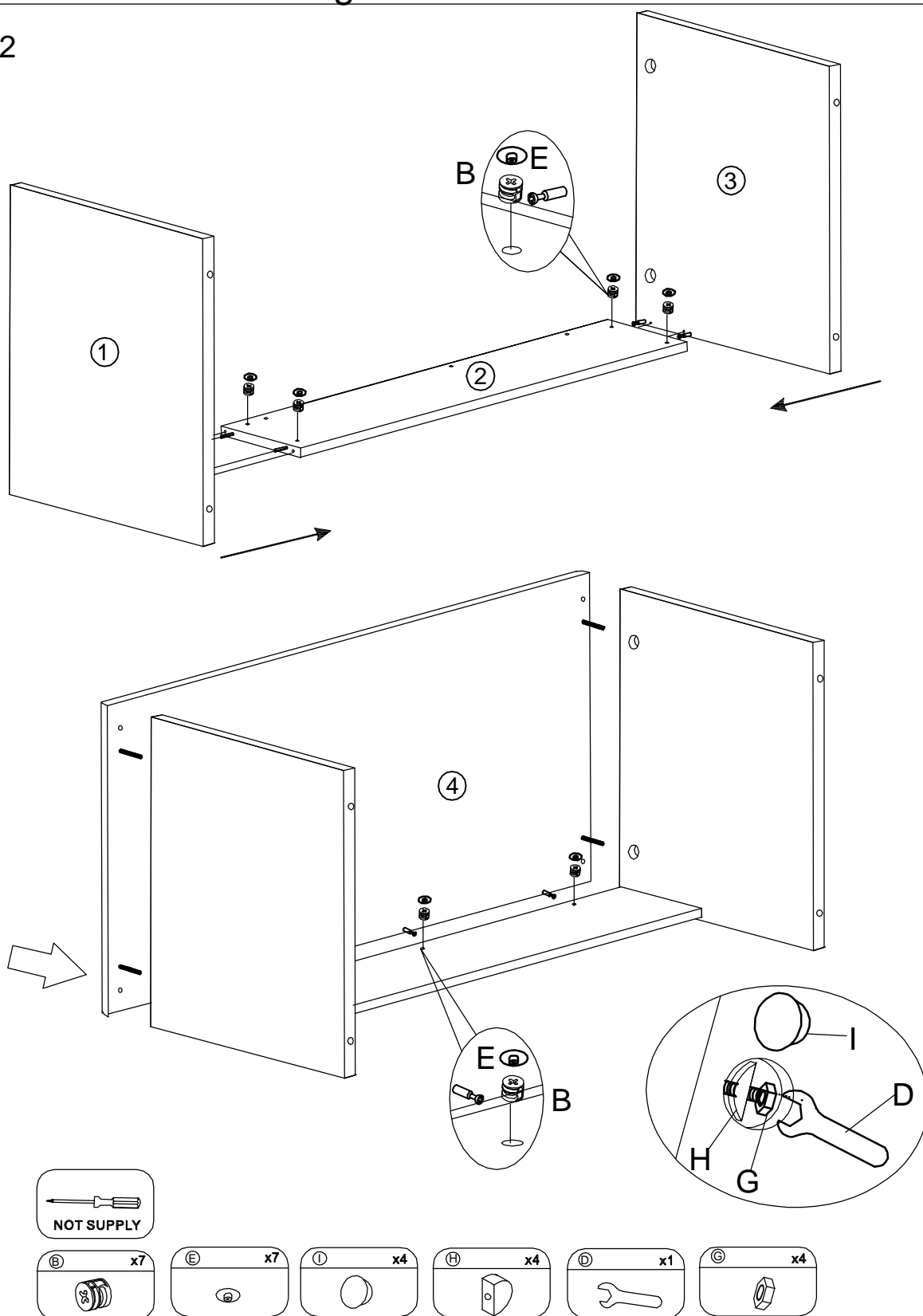

Step 3

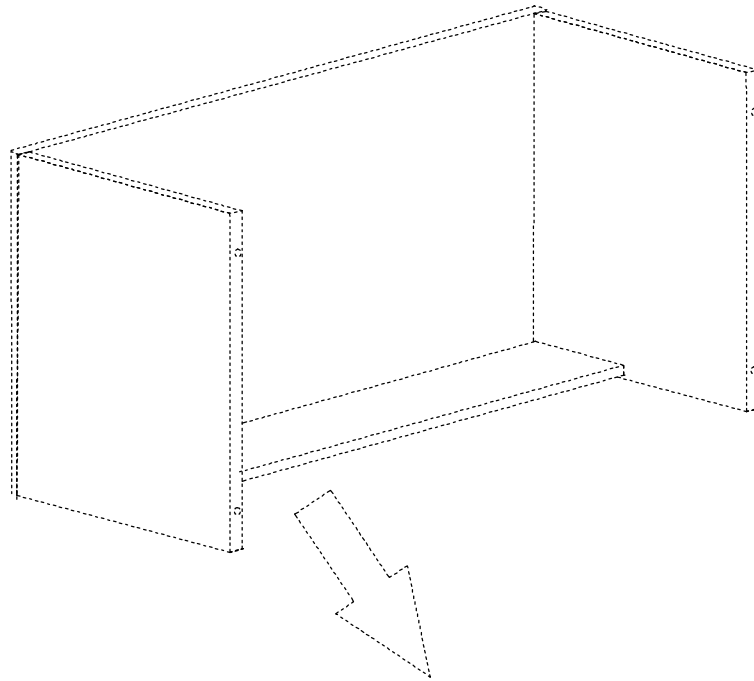

Maximum Load Capacity: 50kg

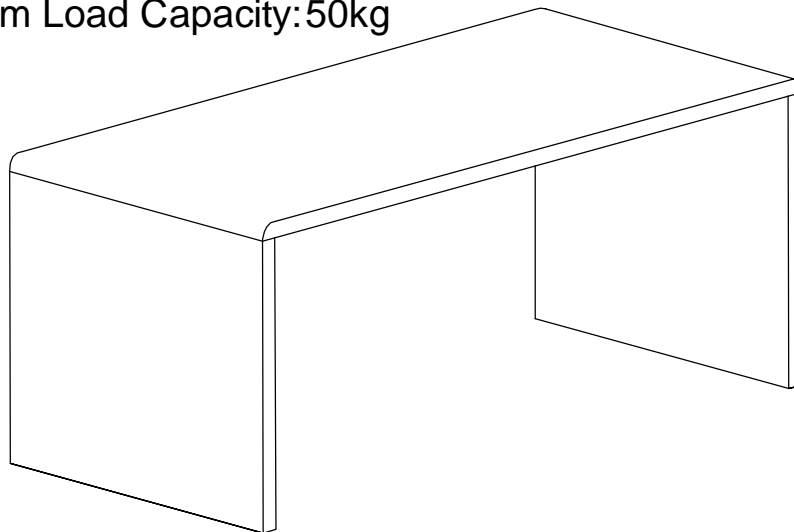

Your ARC DESK is now complete and ready for use.

Officeworks Superstores Pty Ltd. | 236-262 East Boundary Road | East Bentleigh | 3165 | AUSTRALIA.